

Ecoflo®

WASTEWATER TREATMENT

OUR
100%
NATURAL
SANITATION
SYSTEM



**BASED ON COCONUT
HUSK FRAGMENTS**



**REGISTER YOUR PRODUCT TO BENEFIT FROM THE
MANUFACTURER'S VISIT AND ACTIVATE YOUR WARRANTY**

- + resistant**
Improved design for better resistance - (built-in reinforcements)
- + complete**
Integrated lifting and sampling compartment (optional pump)
- + economical**
Replacement of coconut fragments every 12 to 15 years
Emptying of the tank approximately every 6 years
Maintenance once every 2 years
- + waterproof**
Improvement of the seal for the cover and extension



A COMPACT SYSTEM, MOD

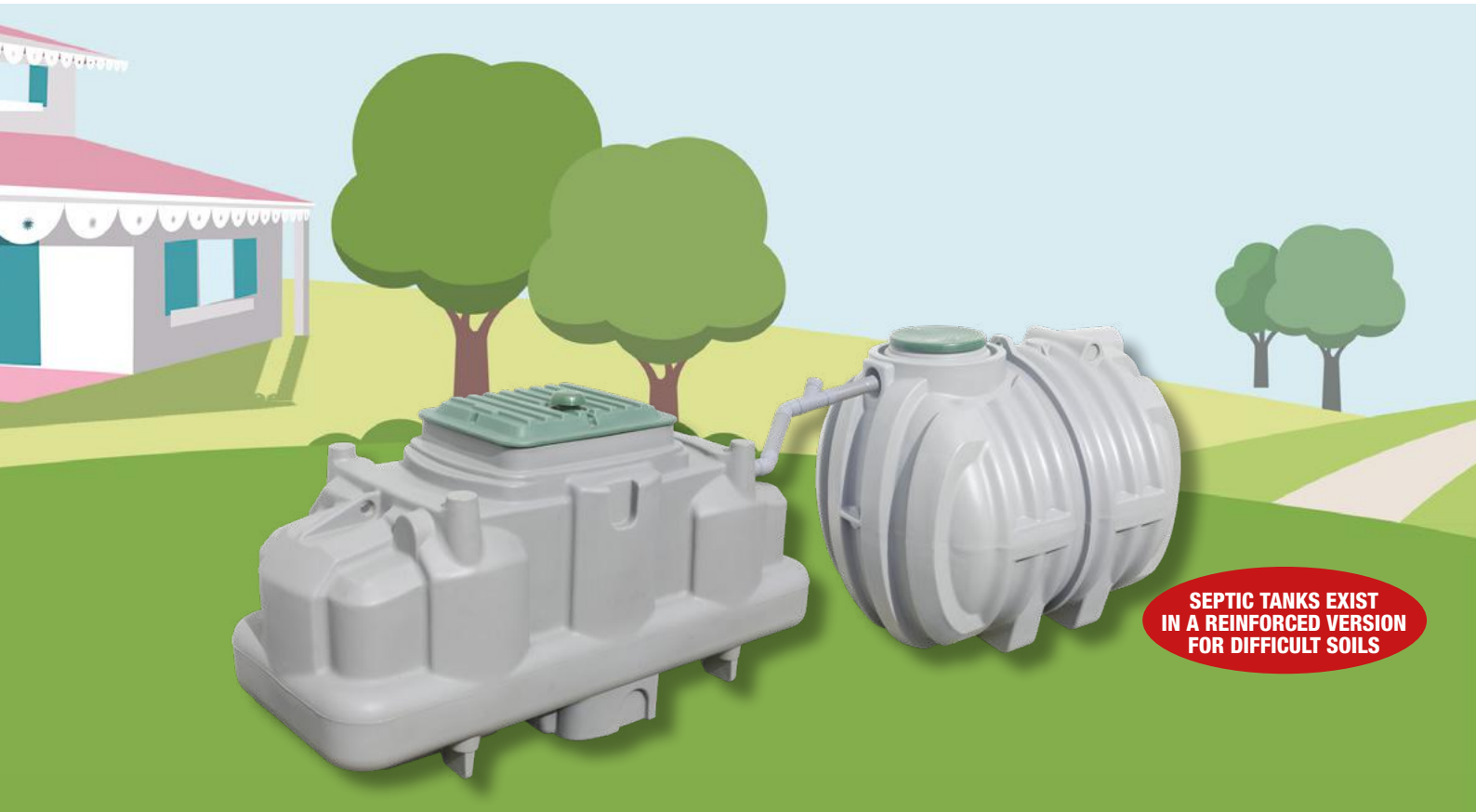

Modularity of the ECOFLO installation

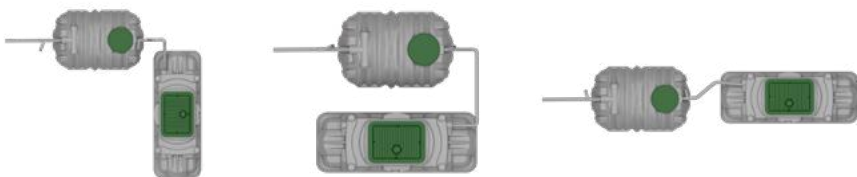

REGISTER YOUR PRODUCT = MANUFACTURER'S VISIT + WARRANTY

Our technician visits every sanitation system installed to verify its proper functioning. Listening to your needs, he advises you and helps you know your installation. You benefit from the dual expertise of the installer and the manufacturer, guaranteeing a high quality sanitation system. This quality verification triggers warranty activation on purification performance.

Ecoflo® Range



(Ext.11 to ext. 18)

Amount of p.e.	Version	Length	Width	Height	FEE	FES	Weight (kg)
5EH	Low output	2,9	1,2	1,4	1,055	0,05	470
	High output*	2,9	1,2	1,4		1,07	480
6EH	Low output	3,45	1,2	1,4		0,05	550
	High output*	3,45	1,2	1,4		1,07	560
8EH	Low output	2 Ecoflo 5 PE + a 2-way gravity distribution box		1,055	0,05	1147	
	High output*				1,07	1157	
10EH	Low output	2 Ecoflo 5 PE + a 2-way gravity distribution box		1,055	0,05	1147	
	High output*				1,07	1157	
12EH	Low output	2 Ecoflo 6 PE + a 2-way gravity distribution box		1,055	0,05	1390	
	High output*				1,07	1400	
15EH	Low output	3 Ecoflo 5 PE + a 3-way gravity distribution box		1,055	0,05	1390	
	High output*				1,07	1400	
18EH	Low output	3 Ecoflo 6 PE + a 3-way gravity distribution box		1,055	0,05	2096	
	High output*				1,07	2151	
20EH	Low output	4 Ecoflo 5 PE + a 4-way gravity distribution box		1,055	0,05	2327	
	High output*				1,07	2382	

Septic tank **	Length (m)	Width (m)	Height (m)
3m³	2,00	1,60	1,70
4m³	2,55	1,60	1,70
4m³	2,55	1,60	1,70
5m³	3,10	1,60	1,70
6m³	3,65	1,60	1,70
8m³	3,50	2,00	2,06
10m³	4,42	2,00	2,06

DULAR AND EFFICIENT

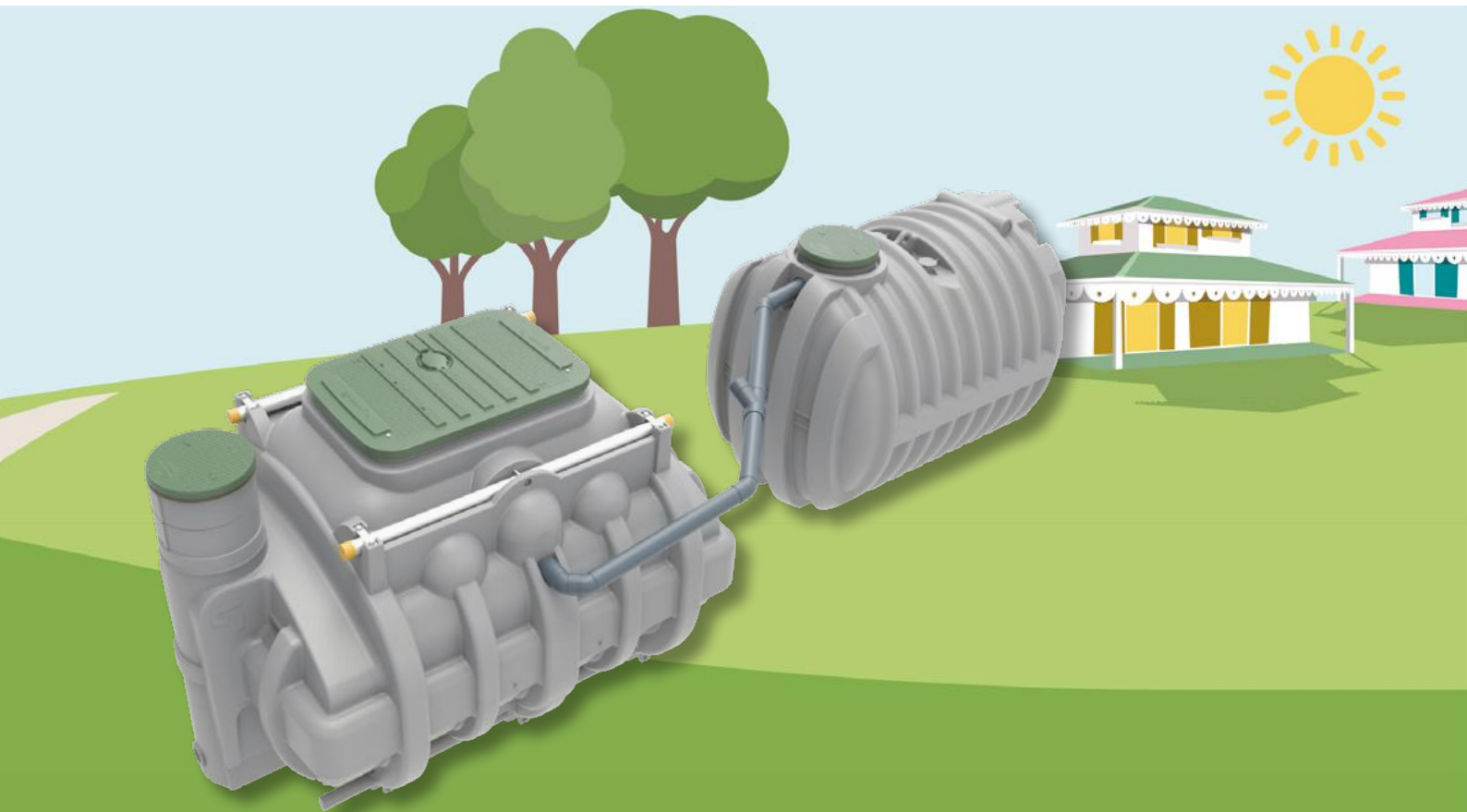

Raw material

Choice of coconut husk fragments as filtering medium:

- Renewable filtering medium,
- Recyclable and reusable
- Fair trade production



Design and Manufacturing

Design certification: DTA
Manufacturing certification:

- QB certification for the construction industry
- French design and manufacturing



Usage

- No electricity
- Easy to use
- No harmful discharge for the environment and health
- Can be repaired

Ecoflo® Monobloc Range (Certified)



(Ext.44 to ext.49)

Amount of p.e.	Version	Length	Width	Height	FEE	FES	Weight (kg)	Septic tank**	Length (m)	Width (m)	Height (m)
8EH	Low output	3,12	2,25	1,82	1.21/-0.61	0.09/-1.73	850	4m ³	2,55	1,6	1,7
	High output*	3,12	2,25	1,82	1.21/-0.61	1.56/-0.26	850	4m ³	2,55	1,6	1,7
10EH	Low output	3,12	2,25	1,82	1.21/-0.61	0.09/-1.73	850	5m ³	3,1	1,6	1,7
	High output*	3,12	2,25	1,82	1.21/-0.61	1.56/-0.26	850	5m ³	3,1	1,6	1,7
12EH	Low output	4,04	2,25	1,82	1.21/-0.61	0.09/-1.73	1050	6m ³	3,65	1,6	1,7
	High output*	4,04	2,25	1,82	1.21/-0.61	1.56/-0.26	1050	6m ³	3,65	1,6	1,7
14EH	Low output	4,04	2,25	1,82	1.21/-0.61	0.09/-1.73	1050	8m ³	3,5	2	2,06
	High output*	4,04	2,25	1,82	1.21/-0.61	1.56/-0.26	1050	8m ³	3,5	2	2,06
17EH	Low output	6,36	2,25	1,82	1.45/-0.37	0.09/-1.73	1800	8m ³	3,5	2	2,06
	High output*	6,36	2,25	1,82	1.45/-0.37	1.56/-0.26	1800	8m ³	3,5	2	2,06
20EH	Low output	6,36	2,25	1,82	1.45/-0.37	0.09/-1.73	1800	10m ³	4,42	2	2,06
	High output*	6,36	2,25	1,82	1.45/-0.37	1.56/-0.26	1800	10m ³	4,42	2	2,06

* With lifting pump

** See «Septic tanks» fact sheet

ECOPROCESS RANGE

Eco-friendly grouped septic system with coconut fragments

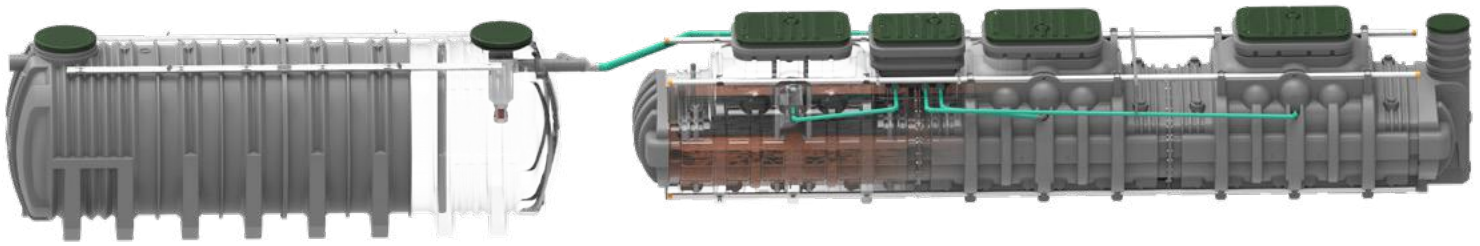

Amount of p.e.	Length	Width	Height	FEE	FES	Weight (kg)	MAXICAP septic tank	Length (m)	Width (m)	Height (m)
26 EH	7,2	2,25	1,82	1,4	0,09	1660	13m ³	5,57	2,00	2,06
38 EH	10,2	2,25	1,82	1,4	0,09	2400	22m ³	8,70	2,00	2,06
52 EH	2 Ecoprocess 26 PE + a 2-way gravity distribution box			1,4	0,09	3335	25m ³	10,75	2,00	2,06
76 EH	2 Ecoprocess 38 PE + a 2-way gravity distribution box			1,4	0,09	4995	35m ³	14,85	2,00	2,06
104 EH	4 Ecoprocess 26 PE + a 4-way gravity distribution box			1,4	0,09	6655	1x30 m ³ in series with 1x13 m ³	12,80	2,00	2,06
								5,57	2,00	2,06
114 EH	3 Ecoprocess 38 PE + a 3-way gravity distribution box			1,4	0,09	7500	1x30 m ³ in series with 1x16 m ³	12,80	2,00	2,06
								6,59	2,00	2,06
152 EH	4 Ecoprocess 38 PE + a 4-way gravity distribution box			1,4	0,09	9600	1x40 m ³ in series with 1x30 m ³	16,90	2,00	2,06
								12,80	2,00	2,06

BEST PURIFICATION PERFORMANCE

Coconut filters are one of the best individual wastewater treatment systems: since 1995 in North America and since 2006 in Europe and 2008 in the West Indies-Guiana, the coconut filter has offered very efficient purification whatever the conditions.

Average results** of the Premier Tech compact coco filter

PARAMETERS	REQUIREMENTS ORDER OF MARCH 2012	TREATED EFFLUENT (ECOFLO OUTPUT)
TSS(mg/l)	< 30	13 ¹ (96,4%)
BOD5(mg/l)	< 35	10 ¹ (97%)
		11 ² (97%)

Exceptional performance of the coco filter, stable under all conditions: permanently below 15mg/L in TSS, whereas the decree of September 7, 2009 requires discharges after treatment to be below 30mg/L.

**Raw water test at 3611 mg/l TSS, 3101 and 3432 mg/l BOD5.

1- Average of 26 assessments carried out according to the requirements of standard EN 12566-3

2- Average of 16 assessments carried out with the most concentrated raw effluent according to the requirements of standard EN 12566-3

PERIPHERAL EQUIPMENT AND ACCESSORIES

Tank extensions



The Extension fits on the cover
 ø 410 – Total height 35 cm
 Réf : REHV

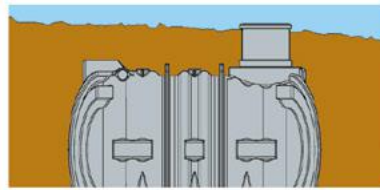

1 EXTENSION ON MANHOLE DN 410
 Useful height 35 cm. Fixing with 4 screws (seal not provided).

The height of the backfill of fine, non-clayey material above the tank is less than 30 cm.

Ecoflo extensions



ECOFLO 5 PE extension
 • 20 and 30 cm
 With integrated seal
 Réf : REHECO2 et REHECO3

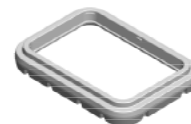

ECOFLO extension 6 PE and more
 • 15 cm
 Réf : REHEPUR

Lifting



ECOFLO® SPECIFIC PUMP

Electrical power : 0.37 kw
Intensity : 1.7 amp
Voltage : Single phase 220-240 volts / 50Hz

Lifting data
 (see manufacturer's fact sheet)

Maximum number of triggerings per hour : 20 per hour maximum in normal operation



CALIDOM

Range of sewage lifting stations with single-phase pumps + possible installation in the ground or above ground



CALIDouble

Range of sewage lifting stations with special pumps (vortex impeller - passage 50 mm)

Grease traps



Grease traps
 200 L - Réf : SEPG200G
 500 L - Réf : SEPG500G



Grease trap extensions
 Useful height 15 cm
 Ref: REHSEP

OTHER VOLUMES ARE AVAILABLE FOR RESTAURANTS, COLLECTIVE KITCHENS... (CONSULT US)

Distribution boxes



GRAVITY DISTRIBUTION BOX
 Available in 2 ways, 3 ways, 4 ways
 Réf : REPGA2V - REPGA3V - REPGA4V



RÉHAUSSE POUR REPARTITEUR
 2 to 4 ways
 Réf : REHSEP



Réf :
 REPSERV2V
 REPSERV3V
 REPSERV4V

OVERFLOW DISTRIBUTION BOX
 (Available in 2 ways, 3 ways, 4 ways) - Factory mounted on each Ecoflo filter (Monobloc / Cluster)
 • Easy to clean • Easy access (wide and offset lid), intuitive and tool-free adjustment

Pre-filter



MANDATORY
 to be put in the septic tank before Ecoflo

ECOFLO : A FILTER TO PROTECT THE ENVIRONMENT

This wastewater treatment system combines treatment performance with space saving. In a restricted space, it allows:

- 1 Primary treatment with a tank that receives all the domestic wastewater and traps the solids.
- 2 Wastewater treatment through a coconut filter. Before being returned to the ground or to an outlet, the water is treated by the best system available, according to tests carried out on 18 technologies during European comparative trials for individual wastewater treatment.
- 3 The filtering medium is made of 100% recyclable coconut fragments of controlled quality. This filter ensures biological treatment, filtration and retention of pollutants until their degradation. It constitutes a real physical barrier which, while protecting the soil in place, ensures the longevity of the infiltration zone.
- 4 Integrated lifting and/or sampling ensures easy installation and increased efficiency.

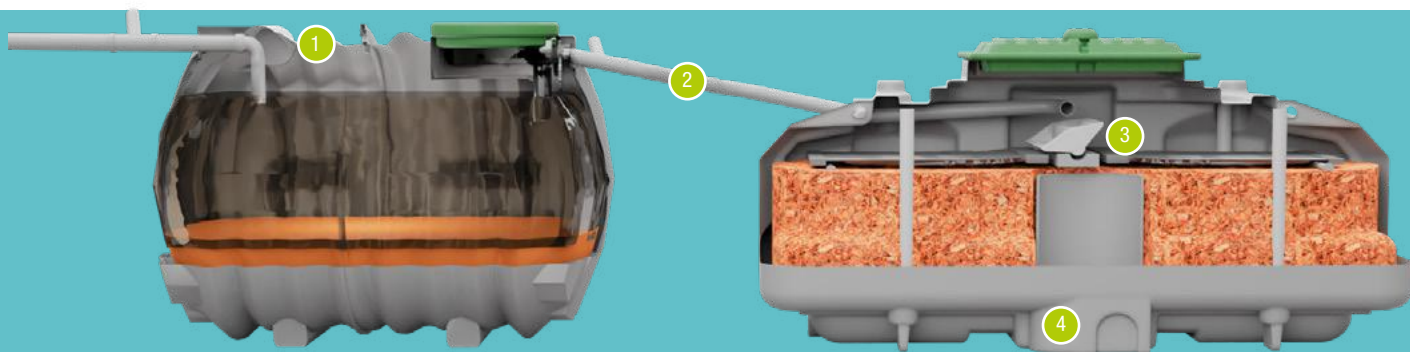

20 YEARS
of hindsight



+ 1000
in-situ measurements



THE MOST
ECONOMICAL

Treatment without electricity
Filter eligible for the Eco zero-rate loan Easy
and quick installation

Maintenance once every 2 years
(except emptying of the tank, « approximately
every 6 years or in case of 50% sludge
accumulation»).



THE MOST
ENVIRONMENTALLY FRIENDLY

Wastewater treatment by a **vegetal filter** with coconut
husk fragments.

After 12 to 15 years of use, the coconut fragments are
renewed and recycled, without any invasive work in your
garden.

Excellent carbon balance thanks to CO2 storage by
coconut trees.



**Natural and
vegetal filter**



**Best known
purification
performance**



**Life expectancy
between 12 and 15
years**



**Renewable residues
that can be reused and
recycled**



A 10-year warranty* for your peace of mind!

Replacement of the used filtering medium is to be performed after 12 to 15 years and allows the renewal of the quality treatment ensured by the coconut filter. The filtering medium is removed by a vacuum truck and replaced for the same period. The used material can be recycled in a composting center.

Important : " The Guides "

All installers must have the installation guide and follow the instructions.
Every owner must have the owner's manual.

**Subject to biannual maintenance

FOR ALL TYPES OF SOIL

These diagrams are presented as an indication, see installation guide on www.procap.fr

1

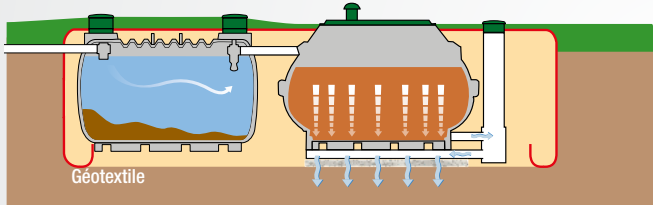

Permeable land

When the soil is permeable and the groundwater is deep, the treated water is infiltrated into the soil via the sampling and infiltration manhole thanks to a gravel area under the coconut fragments compact filters.

2

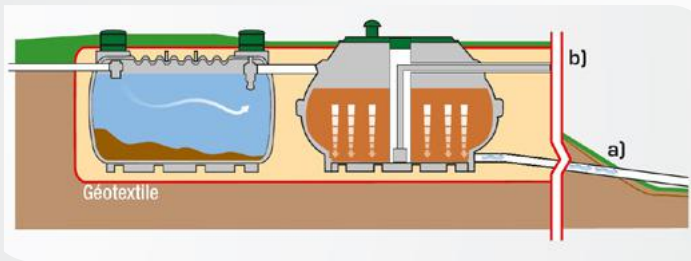

Impervious land

a) With a gravity drainage. b) With a lifting station.

When the soil is impervious, infiltration cannot take place under the compact coconut filter(s) or in its direct vicinity. The collection chamber receives the effluent treated by the Ecoflo coconut filter and the water is conveyed (a) by gravity or (b) by a lifting station to an authorized outlet.

3

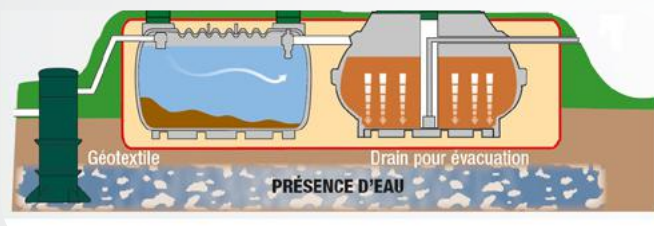

Land with water in the soil at shallow depth

Put the whole installation above ground in a mound with a lifting station upstream or put only the filter in a mound with a lifting station between the tank and the coconut filter. It all depends on the height of the water (you will need gravity evacuation towards a natural outlet). A tank of larger volume or another decanter is necessary to stabilize the water.

4

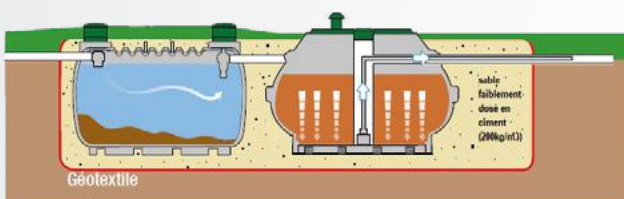

Land subject to flooding

When the ground is floodable, it is recommended to backfill the sewage system with sand dosed at 200 kg of cement/m³ at a minimum height of 30 cm. The evacuation is done by an integrated sampling manhole. Please also see the tank fact sheet.

AN INTERNATIONAL PARTNERSHIP FOR A SUSTAINABLE NON COLLECTIVE SANITATION SYSTEM

PROCAP, THE REFERENCE

Leader in rotational molding, PROCAP is the exclusive partner for the distribution of Ecoflo filters with coconut fragments in the French departments of the American continent. For more than 20 years, PROCAP has been designing, manufacturing and marketing one of the widest ranges of rainwater harvesting tanks, septic tanks and wastewater treatment systems, meeting the current standards and the geological, climatic and seismic constraints of the region.



THE STRENGTH OF PREMIER TECH WATER & ENVIRONMENT

Committed to supporting the local economy and preserving the environment, we protect our planet through our local sustainable solutions that treat wastewater, manage rainwater, store liquids and recycle solid waste. We are deeply rooted in the communities we serve. Together, we keep innovating to create solutions that are environmentally friendly, sustainable and accessible to all. Premier Tech Water and Environment: Passion and Technology have come together to make a difference since 1995 to feed, protect and improve our planet.



MARTINIQUE :
Z.I. Pelletier • 97232 LAMENTIN
Phone : +596 (0) 596 571 023

GUADELOUPE :
Z.I. de Jarry • 651 rue de la Chapelle • 97122 BAIE MAHAULT
Phone : +590 (0) 590 381 414

GUYANE :
15 Lot. Z.I. Collery III • 97300 CAYENNE
Phone : +594 (0) 594 257 494